

| | |
|-------|----------------|
| brand | HURICAN |
|-------|----------------|

| | | |
|------|--------|-----------|
| date | JAN/02 | SHEET 1/2 |
|------|--------|-----------|

| | |
|-------|---------------|
| Model | 653 SP |
|-------|---------------|

| | |
|----------------|------------------------------------|
| Product number | 9538762-14 & 9538762-15 |
|----------------|------------------------------------|

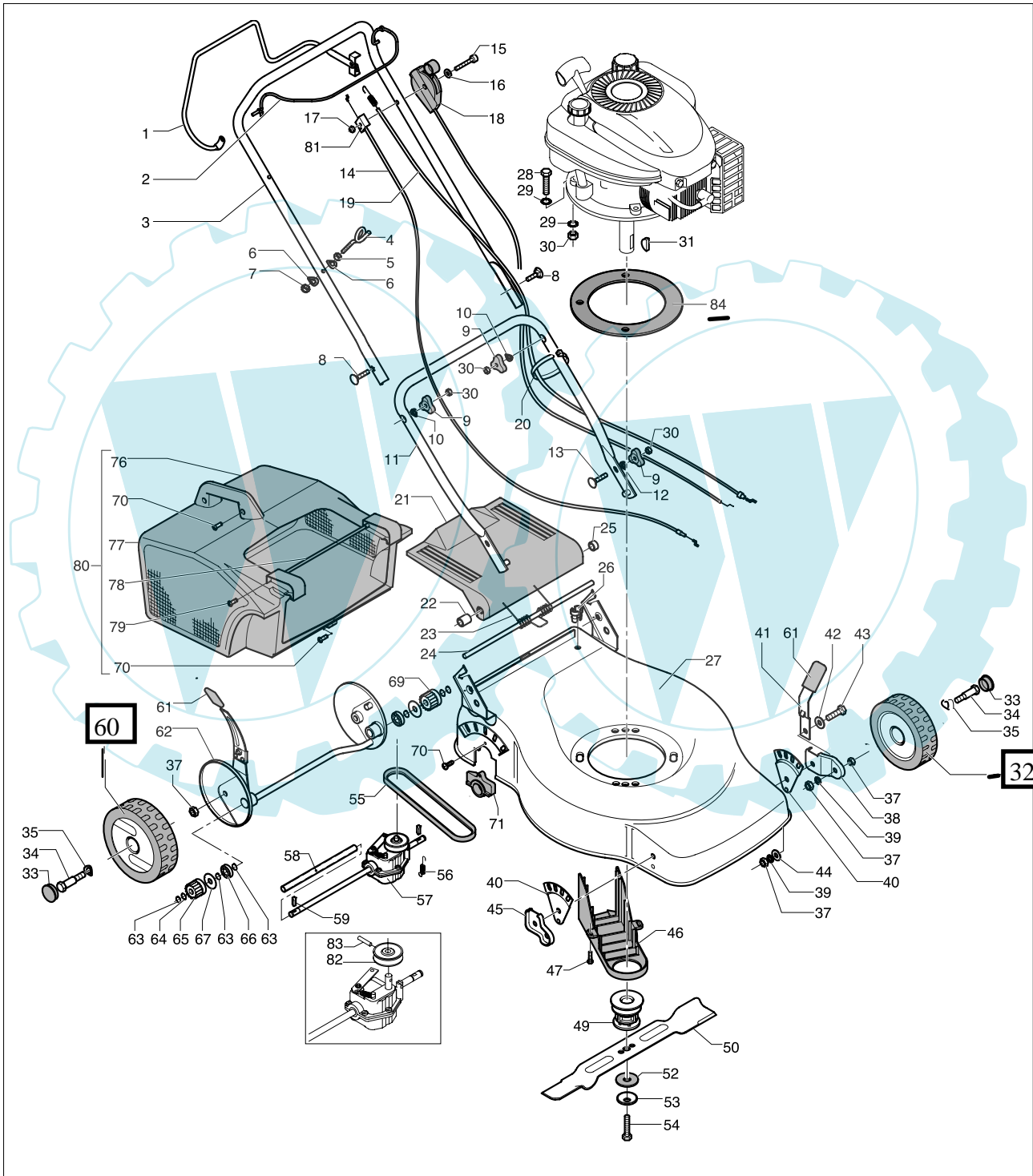

HURRICANE

The Electrolux Group. The world's No. 1 choice.



ELECTROLUX OUTDOOR PRODUCTS

| | |
|-------|---------|
| brand | HURICAN |
|-------|---------|

| | | |
|------|--------|-----------|
| date | JAN/02 | SHEET 2/2 |
|------|--------|-----------|

| |
|--------|
| 653 SP |
|--------|

| Pos | PN ELX | PN MEP | Q.ty | Note | Pos | PN ELX | PN MEP | Q.ty | Note |
|-----|-----------|----------|------|------------------------------|-----|-----------|----------|------|--|
| 1 | 531205616 | 10135883 | 1 | | 40 | 531205925 | 10146010 | 2 | |
| 2 | 531205618 | 10135893 | 1 | | 41 | 531207985 | 20107201 | 2 | |
| 3 | 531206211 | 10155373 | 1 | | 42 | 531206020 | 10146530 | 2 | UNI 8840 B12 (13/24/1) |
| 4 | 531205169 | 10121470 | 1 | | 43 | 531204912 | 10107100 | 2 | |
| 5 | 531207165 | 10501200 | 1 | M6 H6 UNI 5587-6S-ZB | 44 | 531207989 | 20113000 | 2 | 10x30x2,5 |
| 6 | 531204961 | 10115900 | 2 | 6,5E | 45 | 531204914 | 10107301 | 1 | SX |
| 7 | 531208491 | 20281800 | 1 | M6 H8 UNI7473-ZB | 46 | 531206175 | 10155083 | 1 | |
| 8 | 531207089 | 10402401 | 2 | TTSQ M8x50 TF ZB | 47 | 531207856 | 10831800 | 3 | TEFR 5x10 ZB PASSO |
| 9 | 531204923 | 10114303 | 4 | | 49 | 531206169 | 10155040 | 1 | |
| 10 | 531207090 | 10402402 | 2 | 8,5 | 50 | 531207622 | 10700100 | 1 | |
| 11 | 531205711 | 10140053 | 1 | | 52 | 531207243 | 10531700 | 1 | 17,2x50x1,5+0,1 |
| 12 | 531204922 | 10114200 | 2 | 8x16x1,5 ZB | 53 | 531207237 | 10530900 | 1 | 11x50x2,5 |
| 13 | 531204921 | 10114100 | 2 | TTSQ M8x25 T.FIL.ZB | 54 | 531208008 | 20120580 | 1 | TE 3/8 UNFx37 -8,8 1/2F ZB Z29 1/2 (10X750) 3L310 |
| 14 | 531205192 | 10121620 | 1 | 1420/141,5(ALL TEC) | 55 | 531206176 | 10155100 | 1 | |
| 15 | 531206212 | 10155420 | 1 | TE M5x60 UNI 5739-4.8 T.F | 56 | 531205216 | 10121920 | 1 | |
| 16 | 531206666 | 10284700 | 1 | 5/15/1,5 ZB | 57 | 531204755 | 09767400 | 1 | |
| 17 | 531205213 | 10121890 | 1 | M5 DIN 6923 | 58 | 531207697 | 10766503 | 1 | |
| 18 | 531205096 | 10121010 | 1 | | 59 | 531205108 | 10121160 | 2 | "S" 5x5(-0,05) x19,2 DIAG D.210 CON FORO D.13 |
| 19 | 531206191 | 10155290 | 1 | | 60 | 531205624 | 10136074 | 2 | |
| 20 | 531205581 | 10135600 | 2 | 160X4,5 | 61 | 531207986 | 20107203 | 3 | |
| 21 | 531205487 | 10135073 | 1 | | 62 | 531206178 | 10155150 | 1 | |
| 22 | 531205733 | 10140223 | 1 | H.15 | 63 | 531208772 | 20655800 | 6 | D.12E DIN 471 |
| 23 | 531206180 | 10155190 | 1 | | 64 | 531208859 | 20761300 | 2 | D.12,4x17x0,3 |
| 24 | 531205731 | 10140190 | 1 | | 65 | 531205045 | 10120160 | 1 | DX |
| 25 | 531205732 | 10140213 | 1 | H.5 | 66 | 531208778 | 20657600 | 2 | D.12/28/8 6001/2RS |
| 26 | 531205557 | 10135413 | 1 | | 67 | 531207847 | 10831200 | 2 | D.12/34/0,7 ZB |
| 27 | 531204669 | 09155332 | 1 | | 69 | 531205046 | 10120170 | 1 | SX |
| 28 | 531205196 | 10121700 | 3 | TE M8x35 UNI 5739-8,8-ZB | 70 | 531208216 | 20135720 | 5 | TCTC 2F D.5x16 AC |
| 29 | 531207981 | 20106200 | 6 | D.8E DIN 6798 | 71 | 531205944 | 10146093 | 2 | |
| 30 | 531207982 | 20106300 | 7 | M8 H8 UNI 5587-6S ZB | 76 | 531208207 | 20135323 | 1 | SX |
| 31 | 531204907 | 10100900 | 1 | 4x6,5 UNI6606 WODRUF | 77 | 531208203 | 20135313 | 1 | DX |
| 32 | 531205031 | 10120074 | 2 | D.170/13 TACCH. | 78 | 531205547 | 10135330 | 1 | D.8 x 330 |
| 33 | 531204936 | 10114804 | 4 | | 79 | 531207937 | 10878000 | 2 | TCTC 3,9x16 |
| 34 | 531205042 | 10120090 | 4 | | 80 | 531205545 | 10135303 | 1 | |
| 37 | 531207978 | 20101700 | 8 | | 81 | 531208043 | 20121983 | 1 | |
| 38 | 531204915 | 10107302 | 1 | DX | 82 | 531208899 | 20768203 | 1 | |
| 39 | 531208974 | 30102100 | 4 | 10E | 83 | 531207703 | 10768400 | 1 | |
| | | | | | 84 | 531205642 | 10138153 | 1 | |



The Electrolux Group. The world's No. 1 choice.